

ISIKLIKU KASUTUSÕIGUSEGA KOORMATAVA ALA PLAAN

Ida-Viru maakond, Narva linn, Narva linn,
Elektrijaama tee L5

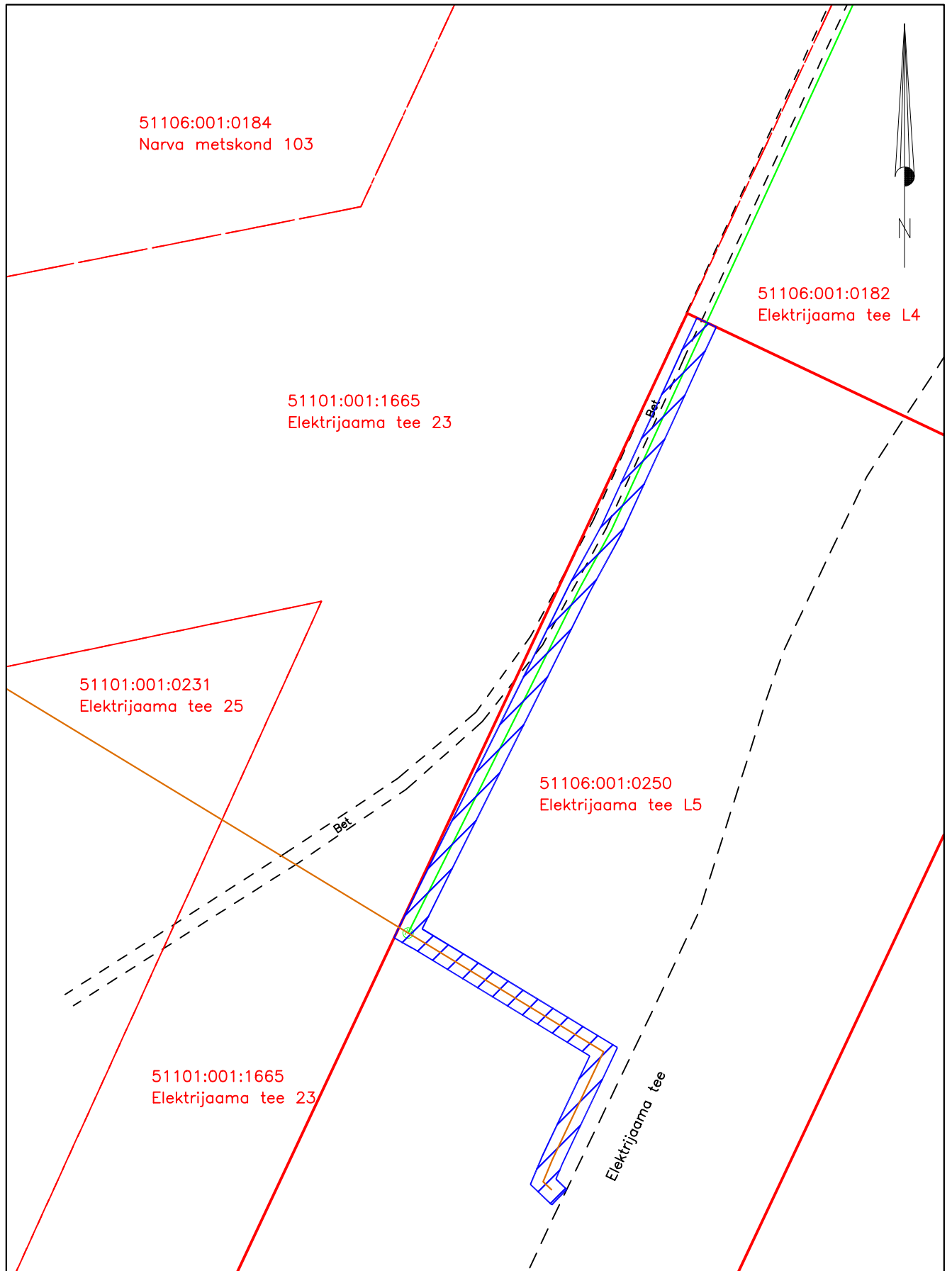



katastritunnus 51106:001:0250; registriosa nr 3914009



Möötkava: M 1:500

Koostaja: Timmo Tampöld

Projekti nr: PF14333

-  Lepingu objektiks oleva katastriüksuse piir
-  Katastriüksuste piirid
-  Projekteeritav sideehitis (Telia Eesti AS)
-  Varem projekteeritud sideehitis (Telia Eesti AS)
-  Isikliku kasutusõiguse ala 201 m²